



# The best of both worlds.

*Come alive in a home at the heart of nature and close to the centre of the city.*

Classique Temple Tree Apartments is situated in California Gardens, a boutique gated community nestled amidst lush greenery. Surrounded by beautiful trees, Classique Temple Tree is an oasis within the city with plenty of outdoor space & easy access to the airport, international schools, healthcare & lifestyle facilities.

3 BHK: 1640, 1670, 1690 SQ.FT | 2 BHK: 1235, 1285, 1290 SQ.FT



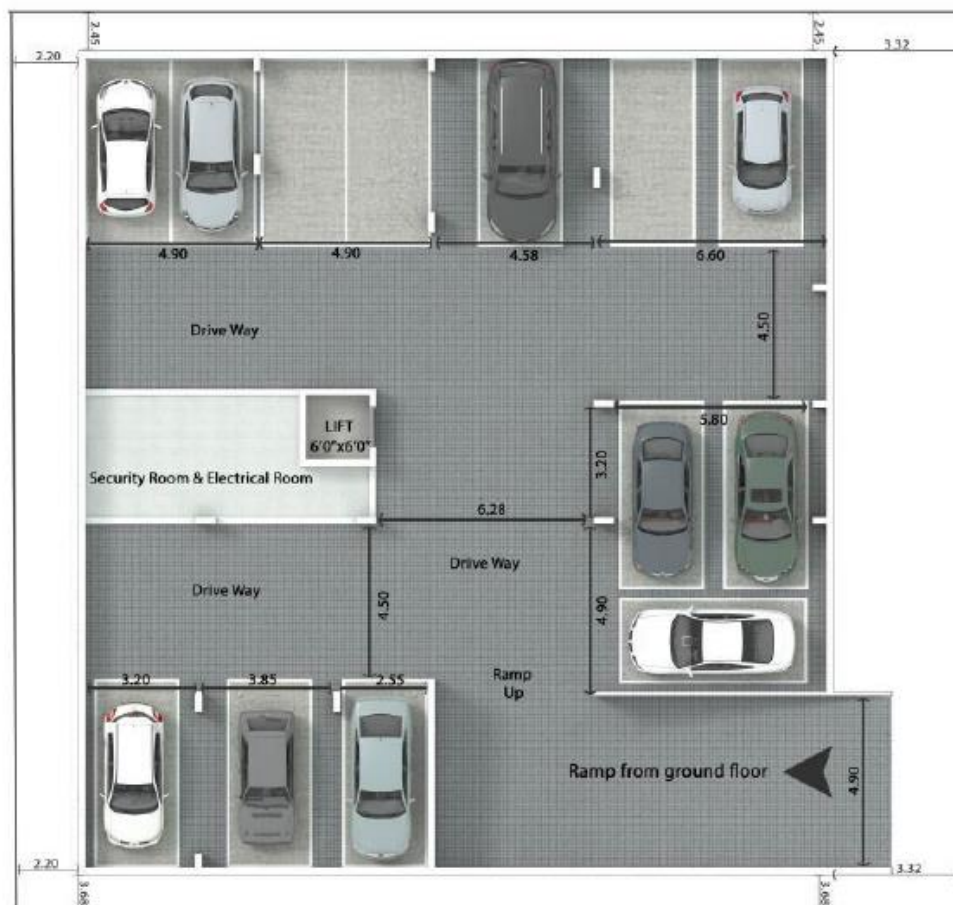



Road

Road







KEY PLAN



Developed By  
  
**MAHABALESHWARA**  
 PROMOTERS AND BUILDERS

**GROUND FLOOR**  
 FLAT TYPE2-3BHK

SUPER BUILT UP AREA - 1640.00 Sqft.  
 CARPET AREA - 1334.34 Sqft



## KEY PLAN



## GROUND FLOOR FLAT TYPE2-3BHK

SUPER BUILT UP AREA - 1640 Sqft.  
CARPET AREA - 1334.34 Sqft



## KEY PLAN



Developed By

**MAHABALESHWARA**  
PROMOTERS AND BUILDERS

**GROUND FLOOR**  
FLAT TYPE3-2BHK

SUPER BUILT UP AREA - 1235.00 Sqft.

CARPET AREA - 1005.84 Sqft



## KEY PLAN



Developed By



## GROUND FLOOR FLAT TYPE3-2BHK

SUPER BUILT UP AREA - 1235.00 Sqft.

CARPET AREA - 1005.84 Sqft







KEY PLAN



Developed By  
  
**MAHABALESHWARA**  
 PROMOTERS AND BUILDERS

**GROUND FLOOR**  
 FLAT TYPE4-2BHK

SUPER BUILT UP AREA - 965.00 Sqft.  
 CARPET AREA - 704.13 Sqft  
 BALCONY AREA - 65.85 Sqft







## KEY PLAN



Developed By  
  
**MAHABALESHWARA**  
 PROMOTERS AND BUILDERS

**GROUND FLOOR**  
 FLAT TYPE4-2BHK

SUPER BUILT UP AREA - 965.00 Sqft.  
 CARPET AREA - 704.13 Sqft  
 BALCONY AREA - 65.85 Sqft







KEY PLAN



Developed By

**MAHABALESHWARA**  
PROMOTERS AND BUILDERS

**TYPICAL FLOOR**  
FLAT TYPE1-3BHK

SUPER BUILT UP AREA - 1690 Sq. ft.

CARPET AREA - 1294.85 Sqft

BALCONY AREA - 72.41 Sqft





Main Door ➔



## KEY PLAN



Developed By

**MAHABALESHWARA**  
PROMOTERS AND BUILDERS

**TYPICAL FLOOR**  
FLAT TYPE1-3BHK

SUPER BUILT UP AREA - 1690 Sq. ft.

CARPET AREA - 1294.85 Sqft

BALCONY AREA - 72.41 Sqft





KEY PLAN



Developed By  
  
**MAHABALESHWARA**  
 PROMOTERS AND BUILDERS

**TYPICAL FLOOR**  
 FLAT TYPE2-3BHK

SUPER BUILT UP AREA - 1670 Sq. ft.  
 CARPET AREA - 1331.55 Sqft  
 BALCONY AREA - 32.28 Sqft

  
 CLASSIQUE  
**TEMPLE TREE**  
 Calicut - Coimbatore

## KEY PLAN



### TYPICAL FLOOR FLAT TYPE2-3BHK

SUPER BUILT UP AREA - 1670 Sq. ft.  
CARPET AREA - 1331.55 Sqft  
BALCONY AREA - 32.28 Sqft







KEY PLAN



**TYPICAL FLOOR  
FLAT TYPE3-2BHK**

SUPER BUILT UP AREA - 1285 Sq. ft.  
CARPET AREA - 1006.92 Sqft  
BALCONY AREA - 33.35 Sqft

Developed By  
**MAHABALESHWARA**  
PROMOTERS AND BUILDERS



## KEY PLAN



Developed By  
  
**MAHABALESHWARA**  
 PROMOTERS AND BUILDERS

**GROUND FLOOR**  
 FLAT TYPE3-2BHK

SUPER BUILT UP AREA - 1235.00 Sqft.  
 CARPET AREA - 1005.84 Sqft





KEY PLAN



Developed By  
  
**MAHABALESHWARA**  
 PROMOTERS AND BUILDERS

**TYPICAL FLOOR**  
 FLAT TYPE4-2BHK

SUPER BUILT UP AREA - 1290 Sq. ft.  
 CARPET AREA - 997.99 Sqft  
 BALCONY AREA - 39.05 Sqft

  
 CLASSIQUE  
 TEMPLE TREE  
 Calibrated Gardens





## KEY PLAN

Main Door



## TYPICAL FLOOR FLAT TYPE4-2BHK

SUPER BUILT UP AREA - 1290 Sq. ft.  
CARPET AREA - 997.99 Sqft  
BALCONY AREA - 39.05 Sqft





20kms from City Centre. 12kms from  
International Airport



Surrounded by lush greenery in a  
gated community

15 apartments

15 apartments in an east facing corner plot  
of area 9000 square feet

---

Basement + Ground + Three Floors

---

4 apartments per floor  
in Typical floor

---

3 apartments  
in Ground floor

---

All corner facing apartments

---

- High Gloss Vitrified Flooring
  - Open Kitchens w/ Piped Gas
  - Granite Vanity Counters
  - UPVC Window Systems
  - Solar Powered Water Heating
  - 40mm safety main door
  - Vaasthu Compliant
  - Backup Power generator
  - Well ventilated
  - Excellent natural lighting
- 

## CONTACT & SALES AGENT DETAILS

98457-22552 | SALES@MPB.CO.IN | MPB.CO.IN

---



Member of **CREDAI**

We are happy to say that we are amongst the pioneers in bringing apartment culture to Mangalore and in the process have seen this small harbour town emerge as a city in recent times. As one of the leading builders's in Mangalore over the last two and half decades, we have made homes for a large number of households in our 26 successfully completed projects. Several other large projects are currently under construction as well. Having successfully completed three projects in Bangalore, with one under construction, we are happy to present our fifth venture - Classique Temple Tree. Armed as it were with our vast knowledge in the field of design, execution and marketing of quality dwellings; we aspire to build happy homes for good many a Banglorean.